

# Welcome to Lund School of Architecture Spring Exhibition 2017

It is with great pleasure we take this opportunity to present selected works of spring 2017. This year's exhibition – the 15th – celebrates the creative process. All four hundred students, from first to fifth year, exhibit their projects in drawings, models and installations. The range of projects is, as usual, wide: from re-making of an old factory in Staffanstorp to the extreme environments of the Philippines.

Lund School of Architecture offers three educational programmes: the five-year programme in Architecture (A), the two-year international Master's programme in Architecture (MARK), and the two-year international Master's programme in Sustainable Urban Design (SUDES). Each semester, the school also hosts around 40 exchange students participating in advanced level courses.

I would like to express my warmest thanks to all students, teachers and other staff who have made this exhibition possible. I would also like to direct a very special thanks to the exhibition coordinators, Klara Bengtsson and Käbi Noodapera Ramel.

We wish you all an exciting time at the School of Architecture.

Christer Malmström  
Head of School, Professor

# Opening Tuesday 23 May at 6 pm A-huset

The exhibition is open  
weekdays 24 - 31 May  
9.00-17.00

Everyone is welcome!

For more information:  
[arkitektskolans.varutstallning@lth.lu.se](mailto:arkitektskolans.varutstallning@lth.lu.se)  
046 – 222 09 01  
Sölvegatan 24, Lund  
[www.arch.lth.se](http://www.arch.lth.se)

## Opening program

Moderator Christer Malmström, Head of School, Professor

- Inauguration by Vice Chancellor Torbjörn von Schantz, Lund University
- Awarding of scholarship in memory of Sara Birnbaum
- Awarding of the students' pedagogical prize
- Gunilla Kronvall, chairman, Architects Sweden Skåne
- Refreshments and snacks

At 19.30 Lecture by Oscar Abrahamsson, presenting his thesis work "In is the new out". Room A:B, Entrance Hall.

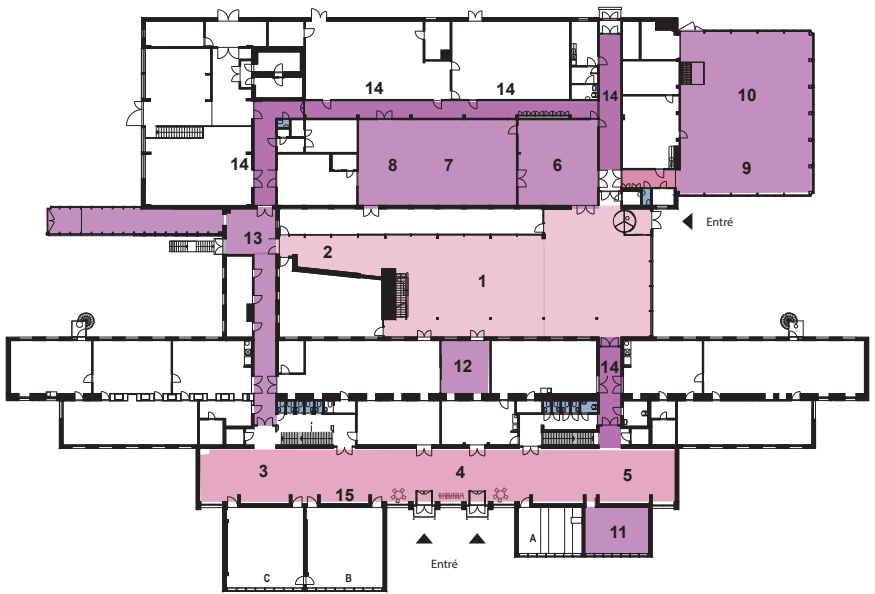

● BASIC LEVEL

● MASTER LEVEL

● BACHELOR LEVEL

● THESIS PROJECTS

1. Atelier Q, X, Y & Z
2. AAHA55 Architectural Design Process and Prototypes
3. AAHF20 Architecture - In Time and Space
4. AAHF30 Architecture - In the Contemporary
5. AAHF25 Architecture - In Context
6. ASEN05 Spatial Experiments II
7. ABVN02 Modernistic Architecture
8. AAHN06 Advanced Architectural Design II
9. ASBN16 Sustainable Urban Landscape
10. ABAN11 Urban Shelter
11. AFON20 Interior Architecture and Furniture Design
12. AAHN15 The Creative Tools of Architecture
13. ABAN15 Climate Smart and Urban Design
14. Thesis projects in Architecture and Sustainable Urban Design
15. "In is the new out", Oscar Abrahamsson at 19.30

# The Ateliers Q, X, Y & Z

## Studio directors

Andreea Marcu (Q)  
Nina Falk Aronsen (X)  
Jesús Mateo (Y)  
Monika Jonson (Z)

## Assisting teachers

Niels Pettersson(Q)  
Hans Ahrland (X)  
Johan Bång (Y)  
Malin Svensson(Z)

## Welcome to the Ateliers!

As a student of architecture in Lund you belong to a studio during the first two years. Students of year 1 & 2 study together in one of our four studios: Atelier Q, X, Y and Z. This not only gives the newcomers valuable guidance in how to approach the learning process in the vast and amazing field of architecture, but it also allows the second-year-students to see their own development and practice the achievements from their previous year.

The majority of the time spent in the studio is focused around project work. Through various design assignments and workshops the students get the opportunity to integrate both academic and artistic skills in their creative design process. Our key objective is to explore & understand how to design and create space with architectural qualities for people. From artefacts and furniture to buildings and cities for a sustainable society.

**Students:****Atelier Q**

1st year:

Elsa Andersson, Fanny Däldborg, Emma Fosse,  
 Mattias Hagberg, Stephanie Harudd, Emanuel Kjellberg,  
 Felicia Larsson, Linnea Lujak, Olof Nilsson, Carl Tengström,  
 Cornelia Valentin.

2nd year:

Julia Berg, Evelina Björndal, Johanna Chieng, Moa Eklund, Nicholas  
 Hartman, Janaka Jansson, Ella Kadefors, Oskar Kylmä, Annika  
 Pålsson, Ludvig Sundberg, Maria Tuvelius, Hanna Wernersson,  
 Denise Ünveren, Fredrik Zanichelli.

**Atelier X**

1st year:

Viktoria Björk, Timothy Burfield, Ulrike Donnerhack,  
 Gabriel Granback, Anton Hansfeldt, Jenna Hukkinen,  
 Hanna Jonson, Susanna Magnusson, Tor Möller, Maria Rinaldo,  
 Julia Svensson, Isak Tengzelius, Tobias Tunebro,  
 Lisa Wennstam, Erika Wågström

2nd year:

Fredrik Bengtsson, Siri Boekhout, Lovisa Eriksson,  
 Ossian Karlsson, Linnea Olsson, Emelie Roos, Martin Sagrén,  
 Erik Selma, Ludvig Wallmon.

**Atelier Y**

1st year:

Grim Axelius, Josefin Ekund, Elin Fritz, Frida Gezelius,  
 Crissie Håkansson, Tobias Lundström, Unni Mattsson,  
 Johanna Olsson, Alexandra Pacoste, Adrian Pagmar,  
 Lina Svantesson, Ludvig Werstam.

2nd year:

Carl Brattberg, Olga Fürst Värild, Linnea Fällman,  
 Robert Garpetun, Tove Helleström, Fatme Hodroy,  
 Martin Håkansson, Isak Jannert, Matilda Katsler,  
 Li-Marie Kåkneryd, Arvin Nadimi, Rasmus Paulson,  
 Tora Pederby, Emma Radler, Jim Sjöholm, Astrid Skånbeck.

**Atelier Z**

1st year:

Simon Cortes, Rickard Dose, Julia Ekman, Samuel Fagerberg,  
 Elisa Heroja, Fanny Hestner, Egil Ljungvist, Sara Modig,  
 Henrietta Munter, Hanna Olin, Sina Rozibay, Kerstin Serin,  
 Emelie Steén, Kathinka Waldenström, Marius Weber, Arvid Westberg.

2nd year:

Linnea Almgren, Arthur Campling, Vida Halleröd, Ellinore Hansson,  
 Viktor Högberg, Nora Rennéus, Calle Sandberg, Steffi Starck,  
 Clas Sundberg, Linda Wiberg, Annika Wikman, Lisa Yngwe.

# Architectural Design Process and Prototypes

Examiner Lars-Henrik Ståhl

Course coordinators  
Marit Lindberg Stefano Santilli  
Andrea Marcu

Exhibition coordinator  
Helene Sveningsson

Teachers

Thomas Hellquist  
Henrik Johanneson  
Akane Moriyama  
Käbi Noodapera Ramel  
Gunnar Sandin  
Malin Svensson  
David Svensson  
Anna Wahlöö Cecilia Wendt

Architects contribute in the making of cities, spaces and places. They design buildings, rooms and items, but in spite of the wide spectrum of work, it is often at an early stage that architects leave their drawings to other operators to continue working on.

This course gives second year architecture students an opportunity to develop an idea from the first sketches to a prototype made by themselves in the workshop, during a period of five weeks. Other professions are also represented in the workshops to inspire the students with different approaches. These approaches might be unfamiliar at first, and offer new insight on the creativity of a design process. It can start anywhere.

This year, the students worked with the concept of cafe interiors.

During the 20th century, cafes became natural meeting points for different groups of people and for different events.

In an urban context, cafes represent a unique position between the private and the public sphere.

The students have analyzed different cafes based on character, atmosphere, interior and social function. Each student has then chosen an already existing piece of furniture, such as a chair from the childhood home, something someone left behind, or a flea bargain.

The selected pieces of furniture were analyzed and converted into something completely new. They were then placed at Marta's Cafe at Lund City Library, and for a period of time they replaced the usual café interiors.

Students

Linnea Almgren, Fredrik Bengtsson, Evelina Björndal, Siri Boekhout, Carl Brattberg, Arthur Campling, Bruno Capelan Köhler, **Johanna Chieng**, Moa Eklund, Lovisa Eriksson, Linnea Fällman, Olga Fürst Värild, Robert Garpetun, Vida Halleröd, Ellinore Hansson, Nicholas Hartman, Tove Hellerström, Fatme Hodroy, Martin Håkansson, Viktor Högberg, Isak Jannert, Janaka Jansson, Ella Kadefors, Ossian Karlsson, **Matilda Katsler**, Oscar Kylmä, Li-Marie Käkneryd, Julia Lyth Berg, Arvin Nadimi, Albin Niemelä, Linnea Olsson, Rasmus Paulson, Tora Pederby, Annika Pålsson, Emma Radler, Nora Rennéus, Emilie Roos, Martin Sagrén, Calle Sandberg, Erik Selma, Jim Sjöholm, Astrid Skånbeck, Steffi Starck, Clas Sundberg, **Ludvig Sundberg**, Thea Felicia Tillberg, Maria Tuvelius, **Ludvig Wallmon**, **Hanna Wernersson**, Linda Wiberg, Annika Wikman, Lisa Yngwe, Fredrik Zanichelli, Denise Ünveren.

# Architecture - In Time and Space

Combining new layers with old.

Studio director  
Tomas Tågil

Examiner  
Christer Malmström

Assisting teachers, tutors, lectures or reviews  
Mattias Andreasson, Eeva Ovaska, Andreas Svenning, Clara Sjödin,  
Ingegård Johansson

The Bachelor Studio Architecture in Time and Space emphasizes how we handle existing building environments. Many buildings have lost their original purpose or they have been abandoned. Still they represent a heritage, an ideal or identity.

Recycling, changing, transformation for new purposes is important for a society to progress and become more socially, economically and environmentally sustainable. This studio course raises questions of how to find new approaches, strategies, to intertwining and anchoring the new with the old, time with space, sometimes in interaction sometimes with confrontation. It also investigates spatial conditions and adds the contemporary through architectural generators,

The studio Architecture in Time and Space has this year worked with the almost abandoned Sugar Refinery in Staffanstorp, built 1885.

Here is a fascinating historical environment that is empty today. It tells a story about the existence of Staffanstorp and it is an important landmark with solid buildings with strong character and readable structures and materials. Our project have been running parallel with the municipality's work with the plan for the future of the entire area.

Students

Caroline Alm, Susanne Bengtsson, Hanna Bramford, Eva Eriksson,  
Emilia Fehniger, Ellen Fällström, Linus Hedrén, Frans Herklint,  
Sophie Hjertqvist, Sophia Jacobsson, Tilda Karlsson, Maria Kempe,  
Ellen Lycke, August Nordqvist, Mark Novotny, Nellie Salgård,  
Astri Sundström Konradsson, Emma Vehmaa Arberg, Elin Westin.



# Architecture - In the Contemporary

Studio director

John Ross

Examiner

Christer Malmström

Assisting teacher

Gediminas Kirdeikis

AAHF30, Architecture - In the Contemporary focuses on digitally-driven design processes aimed at developing novel spatial and structural typologies through the use of surface modeling, parametric modeling / simulation and digital fabrication.

The studio engages in design processes driven by digital methods and examines critically how these methods are evaluated in practice and theory. Special focus is also devoted to contemporary architectural discourse through research and readings.

The design task of a crematorium – the dominant element – is situated in the landscape context of Limhamns kalkbrott. The project work interrogates architectural conventions and encourages experimental approaches to architectural solutions.

Students

Drenusha Blakcori, Viktor Borg, Tobias Brandt, Gabriel Cankalp, Pontus Edrén Dahlgren, Catrin Frid, Magnus Gabrielsson,

Anton Johansson, Amanda Kaplan, Anton Köhler, Hampus Larsson, Erik Lönnbro Fukino, Daniel Nolkrantz, Linnea Pettersson, Rickard Ramberg, Adam Richter, Rasmus Rosenblad, Vera Swahn, Hanna Unell.

# Architecture - In Context

Studio director, Examiner  
Christer Malmström

Teachers  
Emma Nilsson, Bernt Nilsson, Maria Isabel Rasmussen

Extern critics  
Jesper Magnusson, Åsa von Malortie, Mats White

The Bachelor-course is about how architecture relates to the notion of "context". Some professionals sustains that architecture always is about context, others sustains that it does not necessarily need to be so. In regards to this academic polarization we rather put our effort in elaborating further into it through a specific site in a particular place in order to obtain a deeper understanding of what a contextual approach might have as an impact on an architectural project.

Our study-site is placed in Helsingborg along a steep natural ridge running from north to south (Landborgen). Being detached from the coastline only by approximately 100-500 metres, and raised above the sea level about 30, it creates a clearly recognizable element in the urban experienced reality. This ridge has historically deeply influenced the outline of the city. Helsingborg therefore represents an urban reality which extends itself in a narrow but extremely long urbanized area along the coastline.

In terms of cultural and socio-economical realities (education, working-conditions, health, economical resources) we know that urbanized areas such as cities very often shows a significant difference, a "splitt", between its parts. This "splitt" is most of connected to a recognizable physical element. In the case of Helsingborg "Landborgen" constitutes that element thus creating a difference between south and north. Our interest in "Landborgen" is therefore if this once dividing element today instead could act as a connecting one.

As a "second layer" in this course we put strong emphasizes to the representation in section (the vertical cut through an ambient). This since we believe that architects to much use the plan (horisontal cut) and different kinds of volumetric representations in their work process and therefore also in their final communication with others. We therefore approve the usefulness of the section as a working tool in our strive for a real three-dimensional approach to architecture.

Students  
Mats Andersson, Jeanna Berger, Linn Boekhout, Julia Eliasson,  
Amanda Forser, Alice Franzon, Elias Grip, Johannes Håkansson,  
Erik Hildorsson, Anna-Maria Hilmersson, Astrid Keding,  
Emelie Landström, Fabian Martinsson, Amanda Möller, Daniel  
Rosengren, Nicolas Tennberg, Hugo Tersman, Sigrid Thunberg,  
Johan Torarp.

# Spatial Experiments II

Teachers  
David Andreen, Ana Goidea

Examiner  
Lars-Henrik Ståhl

Spatial Experiments II explores the possibilities, challenges, and methods of computational design and digital fabrication in a European and global context. Taking on the task of designing a building to be built using construction scale additive fabrication, the students explore the evolving role of the architect in a digital society, learning and exploring the theories, tools, and processes that follow with the culture and technology of the digital. We explore concepts such as emergence, self-organisation, mass-customisation, and algorithmic design. The studio pursues an experimental research agenda, where depth, individuality, creativity, and investigation are prioritized over completeness, and together we seek to build a vision of where the architect and the architectural process is heading in the near future.

Students  
Johan Bernmark, György Ängelkott Bocz, Hung Bui, Vera Ceginskas Lindström, Monika Jachimowska, Viktor Johansson, Malka Logo, Hany Elhassany, Karolina Mieszczanek, Felicia Olofsson, Piotr Sokolowski, Brigitta Gulyas, Lior Hobashi, Johanna Jonsson, Ablin Karlsson, Sara Ros Ellertsdóttir, Joanna Sabak, Sabrina Schulze, Emil Söderlund, Nataly Timotheou, Astrid von Heideken, Petter Wallin.

# Modernistic Architecture - Renewal i-heritages & barriers

Studio directors  
Thomas Hellquist and Ingela Pålsson Skarin

Assisting teachers  
Agneta Hahne, Frans Liliedahl, Sibylla Wiegert, Anna Wahlöö

The aim with the spring's studio Modernistic Architecture – renewal is to study the architecture of the modernistic movement through sketching infills during Project 1 and transformations in Project 2. In Project 1 the new residential project shall aim at reclaiming the architectural expression of Modernism. In Project 2, the first task is to reunite Malmö's city centre with the harbour area which was cut off by the railway tracks in the 19th century. The second assignment is about transforming the Silo Polstjärnan (North star) into a bridgehead and node for public use. It stands at the other side in the expanding Nyhamnen and by this new link we thereby can preserve a unique industrial heritage and bring back the coasts to Malmö. We will analyse existing and transformed silos sites for guidance. Our inspirational "tools" are value assessments, existing constructions/materials and its contexts in order to design a sustainable transformation project. During Project 1 we base the new infill concepts on a set program. In Project 2, starting in March, you will develop a couple of program to choose from for the final silo transformation project.

The main themes of the spring semester will be;

- Project 1; Bauhaus in Lund, an infill project at Västerport
  - Study trip to the city of Hamburg and its surroundings
- Project 2; The bridgehead Silo Polstjärnan (North star); a transformation project to preserve an industrial heritage at risk in Nyhamnen.
- Theory week; literature and analyse studies on modernism, program design & value study
- Construction week; site documentations, analyses, lectures and assignments

Students  
Marie Andersson, Karl Båth, Johannes Ellebrant, Robin Engnell, Santiago Giraldo Ruiz, Juliette Gleeson, Clemens Hasslinger, Tove Hidemark, Ludvig Holtenäs, Sadhbh Hynes, Nicklas Ivarsson, Elizabeth Lenny, My Lundström, Fredrika Lönnaeus, Josefina Nilsson, Tim Näsling, Theophile Ray, Vera Sophie Schabbon, Salome Schepers, Karl Schiller, Nadine Schulmberger, Maria Sjöström, Axel Svensson Löttiger, Alex Svärd, Oskar Wallin, Olivia Ytterström, Rasmus Ylander.

# Advanced Architectural Design II

Studio director  
Christer Malmström

Assisting teachers  
Andrea Marcu, Jesús Mateo, Alex van de Beld.

Theme  
How to bring back and integrate production in our dwelling environments in the city or how to adapt productive areas to accommodate housing in them?

Aim  
Advanced Architectural Design intends to develop individual skills for participating in architectural competitions of certain complexity. Students will work on their readiness for independent participation and will focus on different matters such as interpretation of the clients' demands and the brief, giving easy answers to complex questions, presentation technique, dealing with deadlines, etc.

Two ways to approach Architecture Competitions  
The semester consisted of two parts where the first one was dedicated to research on architecture competitions, with initial exercises and providing an overview of possible strategies. This part was concluded with the participation on a real case internal competition and a later debriefing seminar.  
The second part was the tutored studio work. It was based on the participation on a professional advanced competition (EUROPAN). This part included choice of site, interpretation of the brief and presentation of both an idea and a clear strategy with means of appropriate illustrations and models.  
The two parts were consciously interwoven throughout the semester but the "theoretical" part had a central point in the initial period.

Study trip  
In order to gain a deeper understanding of the theme of the European competition, The Productive City, we took on a trip to Brussels and Antwerpen in Belgium. During this stay we meet with the Bouwmeister Kristiaan Borret (chief architect Brussel) who actually is the inventor of the theme.

Students  
Shadi Alwan, Alex Daniel Bahamonde Gamboa, Sanna Carlsson, Alexander Croll, Martyna Drapisz, Martin Ellmark, David Espuna Espanol, Sara Gråhed, Oriol Gómez Cuberes, Steffen Hinke, Magdalena Hopfner, Henrik Karlsson, Lydia Koedoot, Maja Linse, Yang Liu, Laura Macpherson, Teresa Martinez Pages, Morgan Patterson, Felix Ruder, Karin Ström, Sara Sundstrand von Weissenberg, Oskar Svahn, Hlynur Dadi Sævarsson, Laura Maria de Torres Gutierrez, Tamara Varlamova, Mikaela Wigström.

# Sustainable Urban Landscape

9.

Studio directors

Louise Lövenstjerne (Course Leader, Architect)  
Peter Siöström (ass. Prof., Director of SUDes Master's Program)

Assisting teacher

Cyril Pavlu (Architect, Urban Designer)

During the spring term of 2017, students at the School of Architecture, Lund University, participated in the advanced course 'Sustainable Urban Landscape (ASBN16) and its complementary theory course 'Urban Landscape - Theory and Methods' (ASBN11).

The course of Sustainable Urban Landscape deals with urban design through a greater perspective—the urban landscape. The spring design project begins with the students gaining an understanding for that cities are not isolated from their surroundings. They are no longer isolated urbanities, but must be discussed from a regional perspective and put into a greater contextual setting.

The region of the Oslo fjord was studied in order to gain an understanding of the landscape and its' history. Strategies for the region's future development was formed and after that the students zoomed in on the urban transformation of the city of Moss.

The course focuses on design adhering to the cultural- and landscape contexts. How can cities develop in relation to their setting in the landscape? How can the landscape become a driver for sustainability strategies, and generate new ideas for living in synergy with the natural environment?

For further information please visit our website at  
<http://www.stadsbyggnad.lth.se>.

Students

Ana-Maria Negru, Romania, Asmaa Abdellahy, Egypt,  
Axel Lönnqvist, Sweden, Benjamin Dohrmann, Australia  
Björn Englöv, Sweden, Camilla Göller, Sweden,  
Charlotte Piggott, Sweden, David Olsson Jones, Sweden  
Effrosyni Stamopoulou, Greece, Efthimis Kapsalis, Greece  
Fanny Sundberg, Sweden, Heena Srinivasan, India,  
Isabella Persson, Sweden, Joseph Scotchman, United Kingdom  
Maria Rodriguez, Mexico, Mathilde Marie Severinsen, Denmark  
Mohammad Al Hamwi, Syria, Parvaty Balagopal, India  
Priscila Portugal Jorge, Brazil, Silvia Paris, Italy  
Sofie Norin, Sweden, Sonjaly Juraszek, Brazil  
Viachaslau Kuzmin, Belarus, Viktor Johnson, Sweden  
Viktor Wallström, Sweden, Bo Wen, Australia  
Paul van Amstel, The Netherlands, Tommaso Baiocchi, Italy  
Christoffer Grimshorn, Sweden, Daniel Zahedpour Anaraky, Sweden  
Elinor Thornblad, Sweden, Erik Appelgren, Sweden,  
Malin Markkanen, Sweden.

## Urban Shelter – Metro Manila

Studio director

Johnny Åstrand (Course Coordinator and Examiner)

Lecturers from Housing Development & Management (HDM)

Johnny Åstrand, Arch. MSA, Course Coordinator and Examiner, Ivette Arroyo, Tekn. Lic., MSc. Arch., Lecturer, Erik Johansson, PhD, Civ. Eng., Senior Lecturer, Laura Liuke, Arch. MSA, Lecturer, Maria Rasmussen, Arch. MSA, Lecturer.

Guest Lecturers

Rachelle Navarro Åstrand, PhD. Arch. MSA, FOJAB Arkitekter, Sweden, Member of Review Panel, Maria Faith Varona, MSc. Arch., TAO-Pilipinas/ University of the Philippines, Member of Review Panel, Alma Valenciano, MSc. Arch., National Housing Authority, Virgilio Regala Jr, MSc. Arch., City Architect of Quezon City, Gerardo Martin Ramos, MSc. Arch., DMCI Homes Corporate Center, Makati.

How can architects work with urban shelter design now and in the future?

The expected global population increase of 1.18 billion by 2030 combined with the existing housing deficit (currently 880 million people live in inadequate housing in cities), implies that approximately two billion people will require housing in 2030.

The task of the students in this course is to design a high density resilient housing area for the urban poor in Metro Manila, the Philippines. Important issues include population density, urban segregation, affordability, resilience, public space, safety and security, gender and physical planning, climate smart design, slum-upgrading, finance for low-income housing, organized self-help housing and the role of the architect.

The course is divided into three phases:

- 1 Preparatory studies in Lund.
- 2 Field studies, three weeks in Metro Manila.
- 3 Applications and design in Lund.

The field study was carried out in close cooperation with the University of the Philippines – Faculty of Architecture, the National Housing Authority, DMCI Homes, Quezon City and TAO-Pilipinas.

The design exercise includes design of a residential neighborhood as group work on two alternative sites and individual design of a building. Short films have also been made as group work reflecting on environment, culture and architecture.

Students

Kristoffer Benne, Sweden, Oscar Björkqvist, Sweden, Gene Carlsson, Sweden, Zühranur Celik, Denmark, Elin Daun, Sweden  
Måns Emlund, Sweden, Marcus Froste, Sweden  
Lisa Grubb, Sweden, Cecilia Hansson, Sweden  
Ibrahim Kombarji, Lebanon, Yaroslava Korchagina, Russia  
Erika Muscat, Sweden, Shada Mustafa, Lebanon  
Oskar Nygren, Sweden, Alexander Rundlöf, Sweden  
Amanda Rådahl, Sweden, Klára Zugarová, Czech Republic

# Interior Architecture and Furniture Design - experiments and prototypes

Studio director  
Marit Lindberg

Examiner  
Lars-Henrik Ståhl

Guests, teachers  
Anna Wahlöö  
Johan Suneson  
Anders Hellström  
Luca Frei  
Patrik Bengtsson  
Helle Robertsson

Interior architecture and furniture design - experiments and prototypes. The course emphasis on the artistic, conceptual and practical aspects of interior architecture and furniture design. Investigations are conducted through sketches, experiments and practical investigations.

The students work with prototypes in different materials.

There is a series of lectures given by practicing architects, furniture designers, artists and other professionals concerning ideas, material and practice.

Investigations of artistic, conceptual and practical aspects of interior design are conducted through workshop in different medias such as cardboard, drawing, installation and film. The process leads towards the completion of prototypes in various materials. The production phase is guided by expert consultants who are able to facilitate the students to realize their ideas. They can also advice on and support the material and construction aspects of the work.

Students  
Erik Appelgren  
Sanna Carlsson  
Johannes Ellebrant  
Robin Engnell  
Marcus Froste  
Clemens Hasslinger  
Tove Hidemark  
Lior Habashi  
Ludvig Holtenäs  
Nicklas Ivarsson  
Ibrahim Kombarji  
Shada Mustafa  
Felicia Olofsson  
Theophile Ray  
Felix Ruder  
Vera Sophie Schabbon  
Salome Schepers  
Karl Shiller  
Nadine Schumberger  
Maria Sjöström



# The Creative Tools of Architecture

Course Coordinator  
John Ross

Teachers  
Gediminas Kirdeikis and Jesper Wallgren

The Creative Tools of Architecture aims to provide students with training and knowledge of various tools in the architectural profession. Analog and digital aids are side by side with elements focused on presentation and rhetoric.

The course covers digitally-driven parametric modeling and digital fabrication. Teaching occurs through a series of lectures and software tutorials, where students learn a variety of techniques for modeling, visualization, and computer-aided manufacturing.

In addition to digital fabrication, analog methods of modeling are used for assembly and further modification of physical models.

## Topics

- 3D digital modeling + rendering: NURBS and polygon modeling + visualization using Rhinoceros and V-Ray.
- Parametric modeling: Parametric modeling using the graphical algorithm editor Grasshopper for Rhinoceros.
- Digital fabrication: Computer-aided manufacturing using digitally-driven additive and subtractive machine tools.

## Students

Alaa Alsharaa, Alex Daniel Bahamonde Gamboa  
Alexander Croll, Axel Borhaven  
David Olsson Jones, Elizabeth Lenny  
György Ángelkott Bocz, Henrik Karlsson  
Hlynur Daði Sævarsson, Karolina Mieszczanek  
Laura Macpherson, Malka Logo  
Martin Ellmark, Mikaela Wigström  
Monika Jachimowska, Morgan Patterson  
Nicholas Cunningham, Sadhbh Hynes, Sara Gråhed.

# Climate Smart Architecture and Urban Design

Course Coordinators  
Catharina Sternudd, Erik Johansson

Teachers  
Marie-Claude Dubois  
Louise Lövenstjerne  
Jouri Kanters  
Moohammed Yahia  
Henrik Davidsson  
Laura Liuke

The aim of the course is to give students the possibility to explore how an adequate design of buildings and groups of buildings can minimize negative impact on the climate. It also aims at supporting students' learning on how the built environment in different climates is affected by the microclimate, vegetation, orientation etc. Moreover the aim is to highlight the impact of people's attitude and behaviour towards climate and energy issues.

The course deals with the relation between the built environment and climate issues on micro and macro level as well as their relation to energy use. Through creative assignments it highlights and explores the potential of renewable energy use such as solar heating, solar electricity and wind power. Using architectural tools, the students will also investigate how innovative and creative urban design solutions can contribute to minimized energy use for transport and prevent negative climate impact.

The students learn to use different computer programmes through exercises. The main assignment of the course consists of architectural and urban design of a new development where daylight, energy efficiency, microclimate, renewable energy as well as other sustainability aspects are considered.

Students  
Mohammad Al Hamwi, Parvaty Balagopal, Elin Daun,  
Benjamin Dohrmann, Hany Elhassany, Måns Elmlund, Björn Englöv,  
Lisa Grubb, Sonjaly Jureszek, Yaroslava Korchagina,  
Maja Linse, Terese Martinez Pages, Charlotte Piggott,  
Priscila Portugal Jorge, Effrosyni Samopoulou,  
Elinor Thornblad, Nataly Timotheou, Paul van Amstel,  
Tamara Varlamova, Klara Zugarova

# Thesis projects in Architecture and Sustainable Urban Design

## Thesis projects Architecture

Within the frame of the Degree Project in the 5-year Architectural Programme the students are encouraged to explore and develop their personal profiles in architecture with a wide span in scale and field of focus.

Coordinator: Emma Nilsson

## Thesis projects Sustainable Urban Design

The master thesis in Sustainable Urban Design programme focuses on the physical environment in various scales from detailed design of urban architecture and places to strategies for urban development in the regional scale. The overall objective of the thesis is to investigate how to achieve quality in the urban environment together with long-term sustainability.

Coordinator: Andreas Olsson

**"In is the new out"**  
**Lecture by Oscar Abrahamsson**  
**23 May at 19.30**  
**Room A:B**  
**Welcome!**

Lecture by Oscar Abrahamsson, Bachelor Degree at School of Architecture, Lund University. Master Degree at SCI Arc (Southern California Institute of Architecture) and awarded with SCI Arc Merit Thesis Award 2016.

From the description of the project:

Today, as our cities are becoming increasingly dense - the role of internal spaces are rising as ever-more important in defining urbanity. And in a moment in which our private lives have become exposed and controlled in almost every aspect, the interior has become the eminent space of refuge, providing anonymity and freedom.

In Is the New Out offers a radical reexamination of the interior as the last urban refuge in 21st century Los Angeles, by introducing a new kind of urban configuration, where public life takes place within blank interior voided figures.

By envisioning not only the 'inside(s)' of the city to be turned out, but the 'insides' in themselves to be re-conceptualized as huge voided figures, embedded as part of the surrounding urban fabric, this thesis proposes a semi-internal, semi-autonomous world of interior urbanism that destabilizes the traditional tropes of urban space and proposes a new configuration for an increasingly denser Los Angeles.